

ASSEMBLY INSTRUCTIONS

SEATTLE BASE AND CHASIS

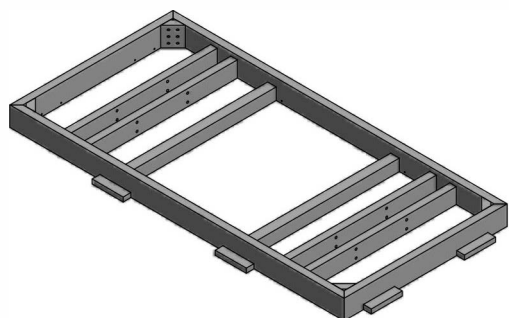

- 1 PLACE THE CHASIS UPSIDE-DOWN ON A PROTECTED SURFACE SUCH AS THE PACKAGING THAT IT CAME IN (SO THAT YOUR FLOOR IS NOT DAMAGED.)

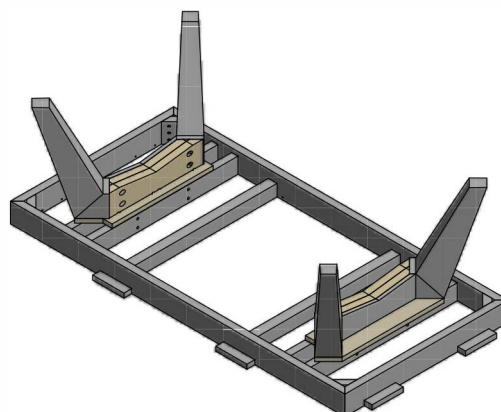

- 2 INSERT THE LEGS AS SHOWN AND LOOSELY INSTALL THE BOLTS AND WASHERS PROVIDED TO HOLD THE LEGS IN PLACE, BUT ALLOWING A LITTLE BIT OF MOVEMENT FOR INSTALLING THE CENTER STRETCHER.

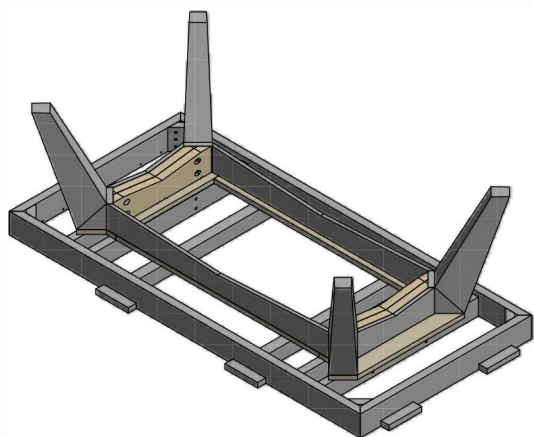

- 3 INSTALL THE CENTER STRETCHERS USING THE SCREWS AND ANGLE BRACKETS PROVIDED. THE STRETCHERS ARE FASTENED TO THE LEGS USING THE ANGLE BRACKETS.

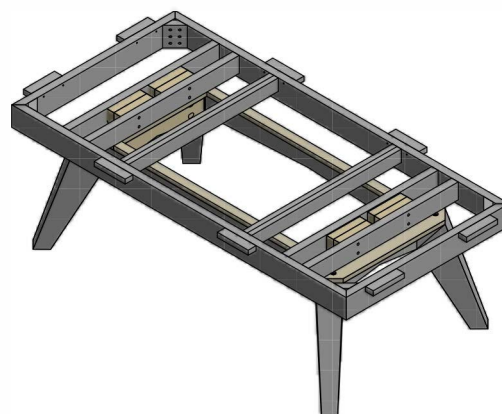

- 4 FASTEN THE OUTER LEGS TIGHTLY. THEN, WITH HELP, TURN THE TABLE UPSIDE-RIGHT.

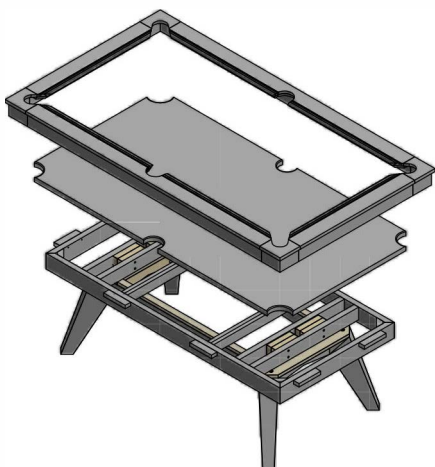

- 5 THE BASE IS NOW READY FOR THE INSTALLATION OF SLATE, BILLIARD CLOTH AND RAILS. REFER TO THE RAIL ASSEMBLY INSTRUCTIONS FOR INSTALLATION OF THE RAILS. HAVE A QUALIFIED TECHNICIAN INSTALL SLATE AND BILLIARD CLOTH.

ASSEMBLY INSTRUCTIONS

INTERNAL POCKET RAIL ASSEMBLY

NOTE: Please remember to use "brads" (included in packaging) to discreetly secure pockets after assembly!



- 1 REMOVE THE NUTS AND BOLTS THAT HAVE BEEN TEMPORARILY ATTACHED TO THE METAL BRACKETS INSTALLED ON THE CORNER POCKET RAIL.

ALIGNMENT
TABS

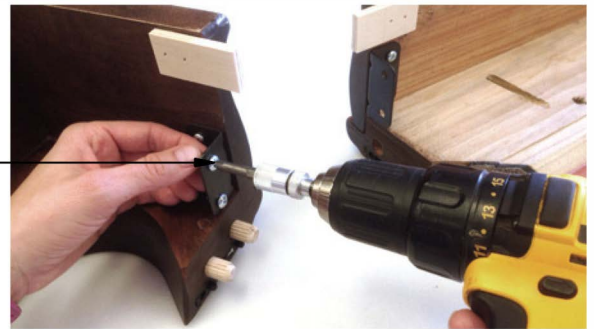

- 2 ALIGN THE DOWELS IN THE CORNER POCKET RAIL WITH THE DOWEL HOLES ON THE STRAIGHT RAIL. PRESS TOGETHER BY HAND. THE WOOD TABS WILL HELP TO ALIGN THE BLINDS.

ALIGNMENT
DOWELS



- 3 USE THE ALLEN WRENCH PROVIDED TO TIGHTEN THE RAIL LOCK FASTENER. SIMPLY INSERT THE ALLEN KEY INTO THE ACCESS HOLE ON THE CORNER RAIL AND TURN CLOCKWISE 90DEG. DO NOT OVERTIGHTEN.

ACCESS HOLE
FOR RAIL LOCK
FASTENER



- 4 USE THE NUTS AND BOLTS REMOVED DURING STEP 1 TO FASTEN THE METAL BRACKETS TOGETHER. THIS WILL CLOSE THE GAP BETWEEN THE CORNER RAIL AND THE STRAIGHT RAIL AND PROVIDE A STRONG CONNECTION.



- 5 REPEAT STEPS 1-4 TO COMPLETE THE ASSEMBLY OF THE INTERNAL POCKET RAIL SET.

